



TunePat Spotify Converter

User Manual

Overview

- [Introduction](#)
- [Key Features](#)
- [System Requirements](#)

Purchase & Registration

- [Purchase TunePat Spotify Converter](#)
- [Register TunePat Spotify Converter](#)

Installation & Interface

- [Installation](#)
- [Main Interface](#)
- [Menu](#)

Tutorials

- [Add Spotify Music to TunePat](#)
- [Adjust Output Parameter](#)
- [Convert Spotify Music Files](#)
- [Tools](#)
- [Feedback](#)

Technical Supports

- [Support](#)
- [Contact](#)



Overview

- [Introduction](#)
- [Key Features](#)
- [System Requirements](#)

Introduction

Thank you for using TunePat Spotify Converter!

[TunePat Spotify Converter](#) is a simple yet powerful Spotify downloader. It lets one download tracks, albums, playlists, audiobooks, and podcasts from the Spotify app or web player and saves them on a computer forever in MP3, AAC, WAV, AIFF, FLAC, or ALAC format at up to 10X conversion speed. Meanwhile, the original audio quality and the ID3 tags will be preserved perfectly after conversion.

With TunePat Spotify Converter, you can easily backup Spotify songs on your local computer, enjoy Spotify songs on various media players, transfer Spotify music from device to device, etc. This software is designed with almost all the features of a qualified, even excellent, Spotify converter.

Key Features

- Export music, albums, playlists, podcasts, audiobooks, radios, music video, and podcast video from Spotify.
- Convert Spotify Music to MP3, AAC, WAV, AIFF, FLAC, or ALAC.
- Keep ID3 tags after conversion.
- 10X conversion speed; Lossless output audio quality.
- Download Ad-free Spotify Music with a Free Spotify account.
- Handy tools include AA/AAX Converter, Audio Editor, Format Converter, Burn CD, Tag Editor, etc.

System Requirements

➤ Windows Computer

- Windows 8 or above;
- 1GHz processor or above;
- Monitor with 1024 x 768 pixels or higher resolution;



Tutorial of TunePat Spotify Converter

- 512 megabytes (MB) or higher of RAM;
- 1GB of available hard-disk space or higher.

➤ **macOS Computer:**

- macOS 11 or above;
- 1GHzprocessor or above;
- Monitor with 1024 x 768 pixels or higher resolution;
- 256MBorhigher of RAM.



Purchase & Registration

- [Purchase TunePat Spotify Converter](#)
- [Register TunePat Spotify Converter](#)

➤ Purchase TunePat Spotify Converter

- To buy a license key for **TunePat Spotify Converter Windows**, click [here](#).
- To buy a license key for **TunePat Spotify Converter Mac**, click [here](#).

1. Why should I buy TunePat Spotify Converter?

TunePat Spotify Converter is a shareware, and the trial version has limits that only enable users to convert the first 1 minute for each file. After you purchase this product, you will receive your Registration Email and Registration key to unlock the trial version limitation.

2. What are the Benefits after Registration?

- You can get access to **the full features** of TunePat Spotify Converter.
- You can enjoy **FREE** upgrades to the latest versions of the same product.
- You can enjoy **FREE** technical supports.

➤ Register TunePat Spotify Converter

Step 1: Click on the **Menu > Register** or your avatar in the lower left corner to open the registration window below and complete the registration process.

Step 2: Then copy and paste the registration **E-mail** and **Code** into the registration pop-up Window. Click on **Register** button.

Step 3: Once the registration process is done, there will be a pop-up dialogue saying **“You have successfully registered the program. Thank you for your support!”**, and it will also show you when your license will expire.

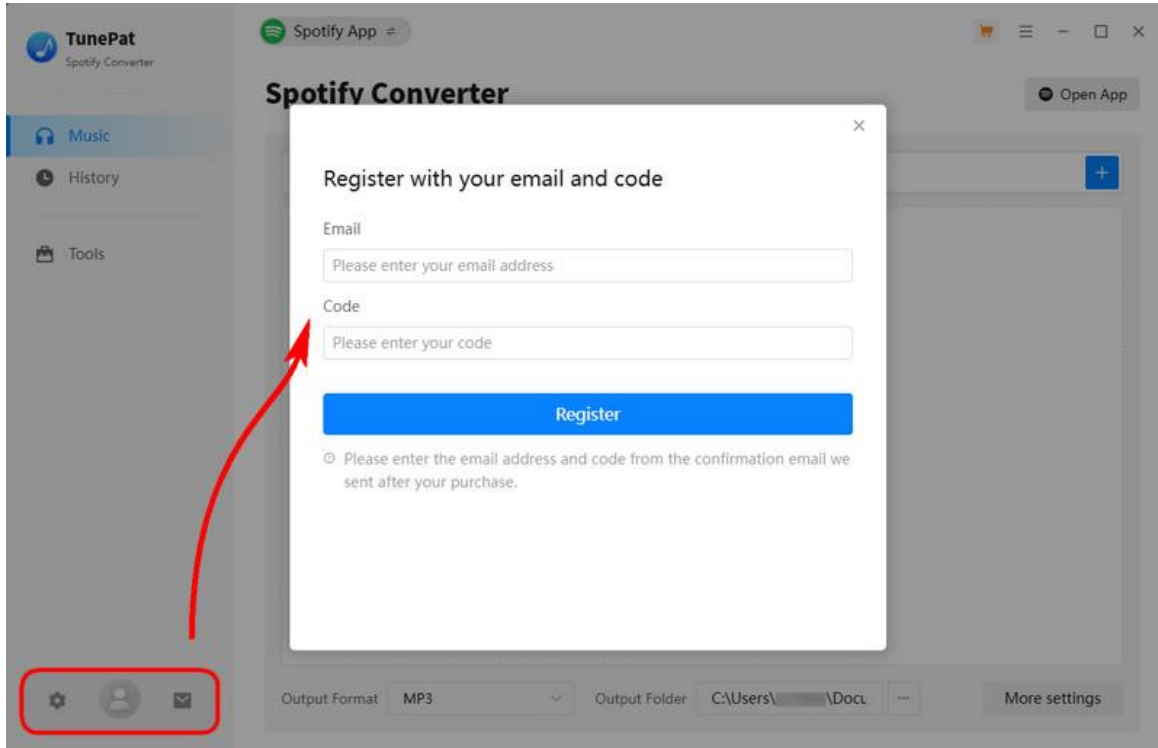

Registration Tips:

1. Make sure your computer is well-connected with the Internet.
2. We suggest you simply copy & paste the **Registration information** into the pop-up dialog.
3. Make sure both **Registration Email** and **Registration key** are provided by our company after purchasing. If you have not paid, please click **Buy Now** to finish the payment and get the license.
4. Please make sure the Registration Email and Registration key you entered are complete, and do not insert any blank before or after them. Otherwise, normal registration will not be possible.
5. A license key of TunePat can only be used by one computer device. If you need to replace the computer, please contact the TunePat customer service team by email to help you deal with it. If you register and use on **multiple devices** at the same time, the registration code will become invalid and you cannot register successfully.
6. In the case of subscription renewal, then complete the registration by these steps: Click on the **“Renew License”** button → Enter the E-mail and the new code you have received on the renewal date. → Tap on **“Confirm”**.

Installation & Interface

- [Installation](#)
- [Main Interface](#)
- [Menu](#)

➤ Installation

To install this product, please refer to the following steps:

1. Download the latest version of TunePat Spotify Converter through [Download Center](#).
2. Double click the “tunepat-spotify-converter.exe” or “tunepat-spotify-converter.zip” file to accomplish a “single-click install”.
3. After installing, you can double-click TunePat icon to launch the program.

➤ Main Interface

When you have the Spotify app installed on your computer, you will see the following interface when you open TunePat Spotify Converter. TunePat will get audio from the app by default, with a maximum sound quality of 320 kbps. You can also click “**Spotify App**” to switch the audio source.

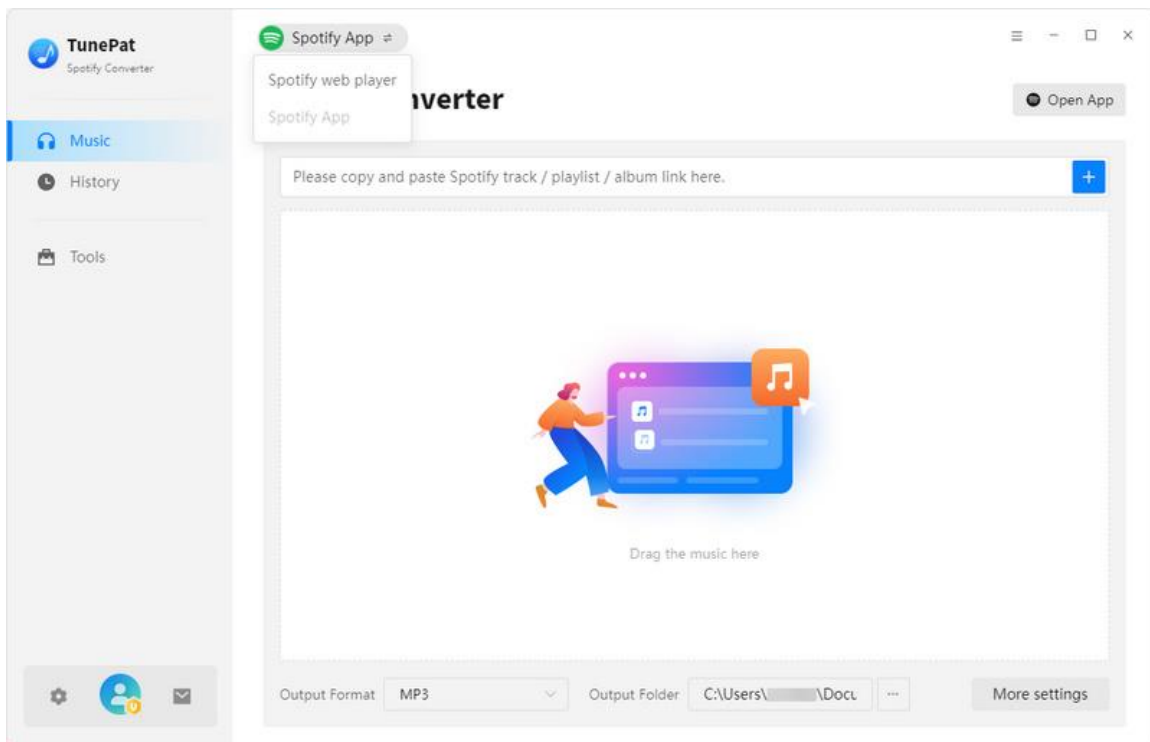



Tutorial of TunePat Spotify Converter

➤ Menu

After clicking the **Menu** button  on the upper right corner of the interface, you'll see the drop-down list as the following picture. Here you can visit **the FAQ center of TunePat, check for update** when a new version is available, **clear cache, open the log files, relaunch the program**, and etc.

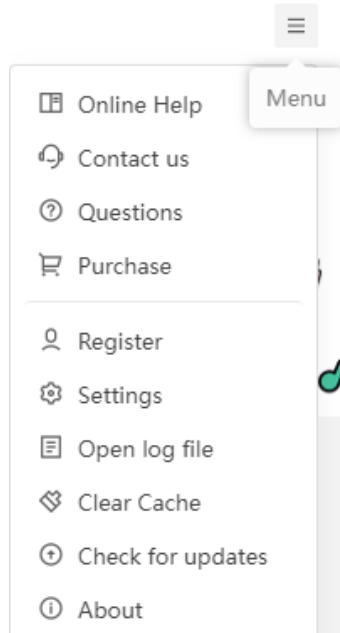

Tutorials

- [Add Spotify Music to TunePat](#)
- [Adjust Output Parameter](#)
- [Convert Spotify Music Files](#)
- [Tools](#)
- [Feedback](#)

➤ Add Spotify Music to TunePat

TunePat can convert music from Spotify app or web player. The conversion speed and audio quality between them are slightly different. For details, please see: [App VS. Web Player Music Downloading](#).

To change the audio source, you can click the button “**Spotify App**”. Here, you can decide to choose convert music from the **Spotify App** or the **Spotify web player**.



To convert music from the Spotify web player, you can have it embedded in the program or have it pop up. You can switch by clicking “**Keep in Converter**” or “**Pop out Player**”.

Log in to your Spotify paid or free account. Browse songs, playlists, albums, audiobooks, or podcasts, open what you wish to convert and click the “**Click to add**” button located in the lower right corner.

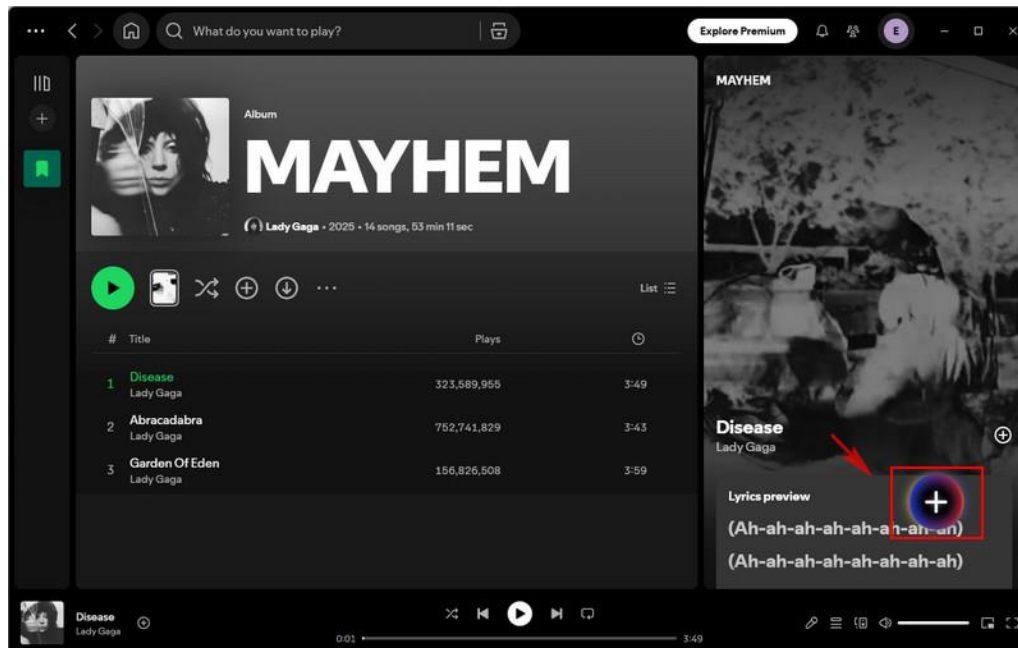



Tutorial of TunePat Spotify Converter

The analyzed content will appear in a pop-up window. All items are selected by default, but you can manually uncheck the titles you don't want. If needed, you can click the **"Filter Converted"** button to filter out songs that already exist in the current local path to avoid duplication. Then, click the **"Add"** button to add these songs to TunePat.

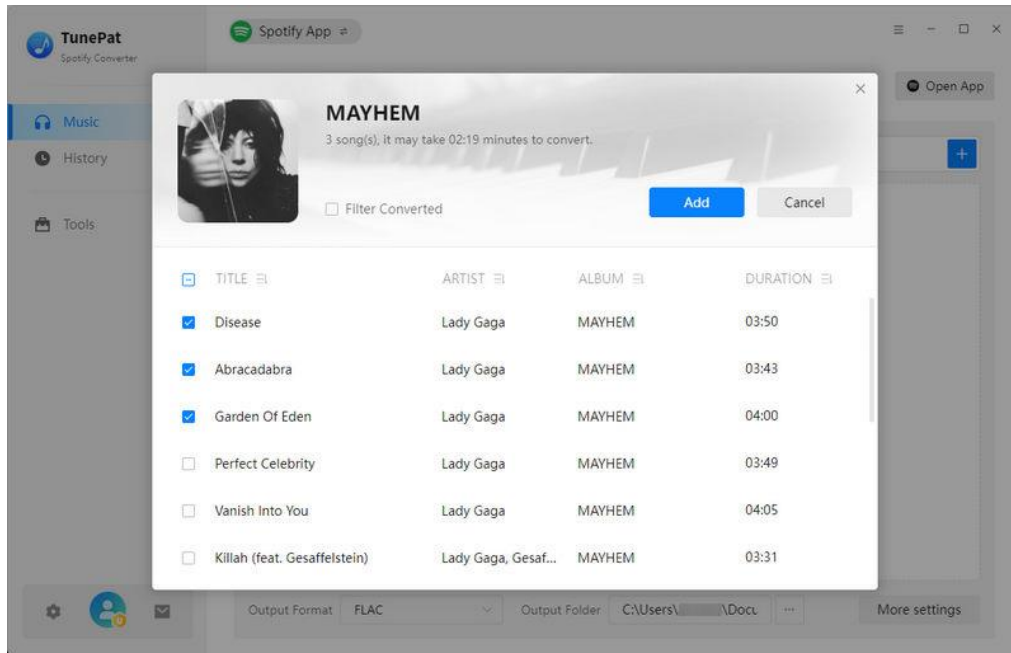

➤ Adjust Output Parameter

Before converting songs, click the "Settings" button. Here, you can complete the customization of multiple parameters. Including the following:

- Output Format: **Auto, MP3, AAC, WAV, FLAC, AIFF, ALAC** [If you want a faster conversion speed, you can select the **AUTO** mode in the **Output Format** column.]
- Bit Rate: **(Very High) 320kbps, (High) 256kbps, (Medium) 192kbps, (Low) 128kbps** [You should know that the highest output quality that TunePat can export depends on the actual quality of the original files.]
- Sample Rate: **44.1 kHz, 48 kHz, 96 kHz, 192 kHz** [Will vary depending on the selected output format; for example, when you choose MP3, only 44.1 kHz and 48 kHz options are available.]
- Save lyrics (if provided): After activating this button, TunePat will automatically recognize, download, and save Spotify song files as **LRC or TXT** files.
- Output File Name: **Track Number, Title, Artist, Album, Playlist Index, Year**
- Output Organized: **None, Playlist, Artist, Album, Artist/Album, Album/Artist, Playlist/Artist, Playlist/Album**



Tutorial of TunePat Spotify Converter

- Language: support 48 languages, including Arabic, Armenian, Azerbaijani, Basque, Bosnian, Bulgarian, Brazilian Portuguese, Catalan, Chinese, Croatian, Czech, Danish, Dutch, English, Filipino, Finnish, French, Galician, Georgian, German, Greek, Hebrew, Hindi, Hungarian, Indonesian, Italian, Japanese, Javanese, Korean, Macedonian, Malay, Maltese, Norwegian, Persian, Polish, Portuguese, Romanian, Russian, Slovak, Spanish, Swedish, Tamil, Thai, Turkish, Ukrainian, Vietnamese, Zulu.

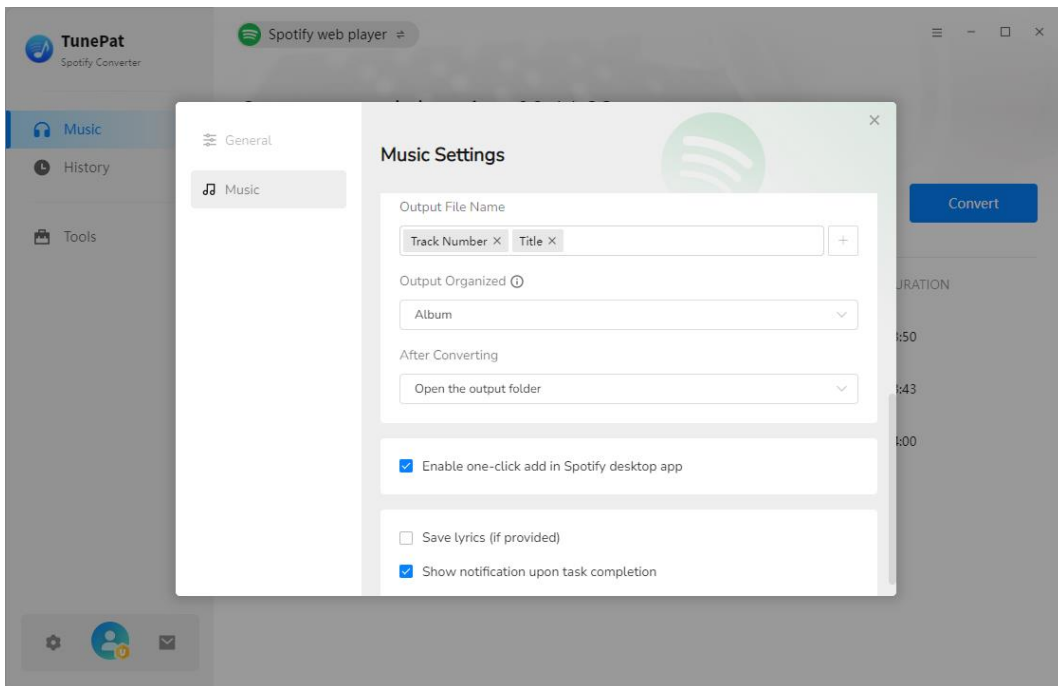
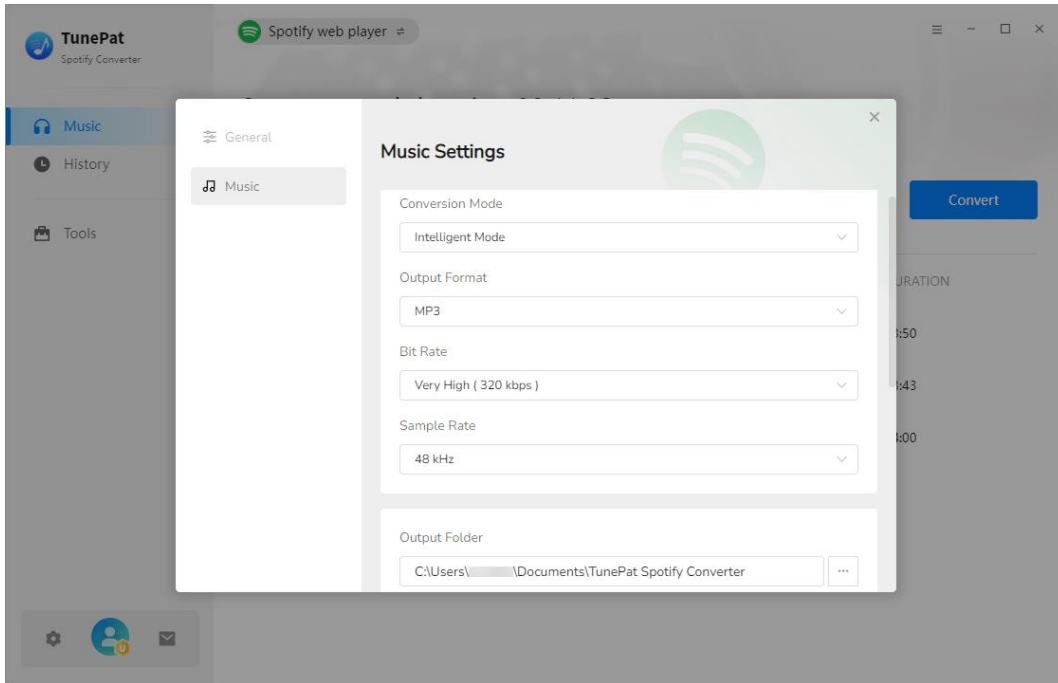

➤ Convert Spotify Music Files

To continue choosing songs from other playlists or albums, please select the **“Add More”** button. Choose the **“Delete All”** button and the current list will be cleared with one click. To start the conversion immediately, please click the **“Convert”** button.

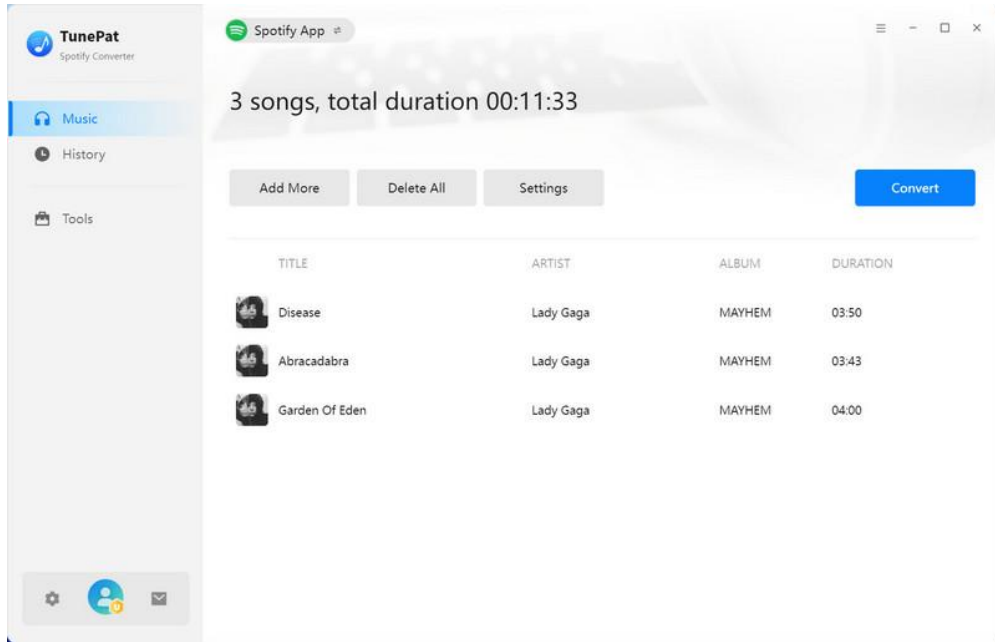

After the conversion is complete, you will see a pop-up prompt. After the conversion is complete, you can click the **“History”** option, where you can browse or play the converted titles. You can also transfer them directly to iTunes or burn them to CD, or transfer them to another device you like.

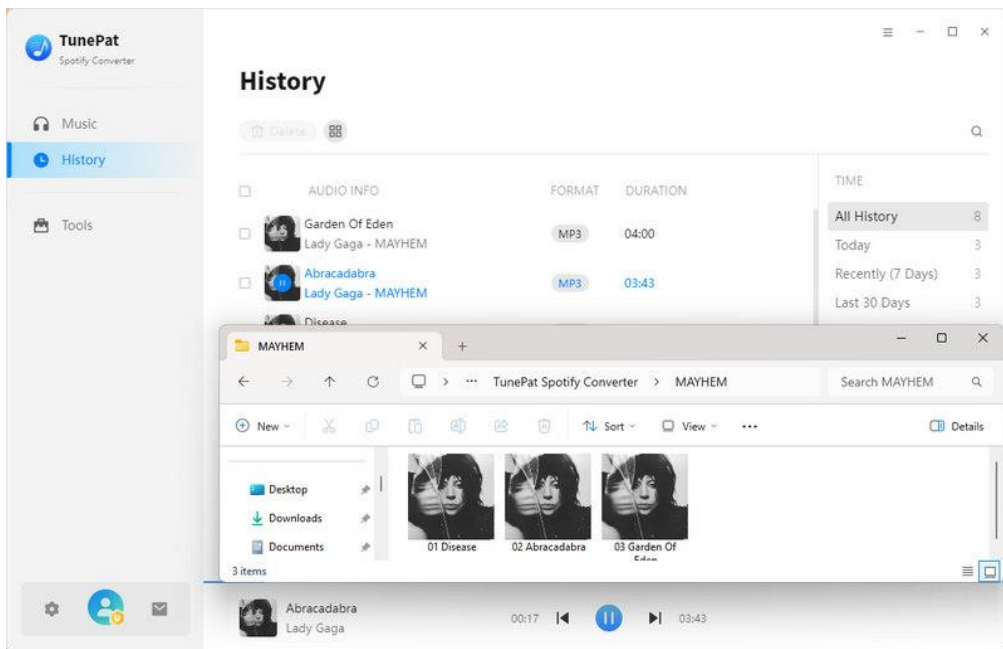

➤ Tools

In addition to converting Spotify Music to standard formats, the remarkable TunePat Spotify Converter offers a range of useful tools. You can access the [Tools](#) option from the left toolbar. Upon clicking, you will find some sections: **AA/AAX Converter**, **Format Converter**, **Burn CD**, **Audio Editor**, and **Tag Editor**.

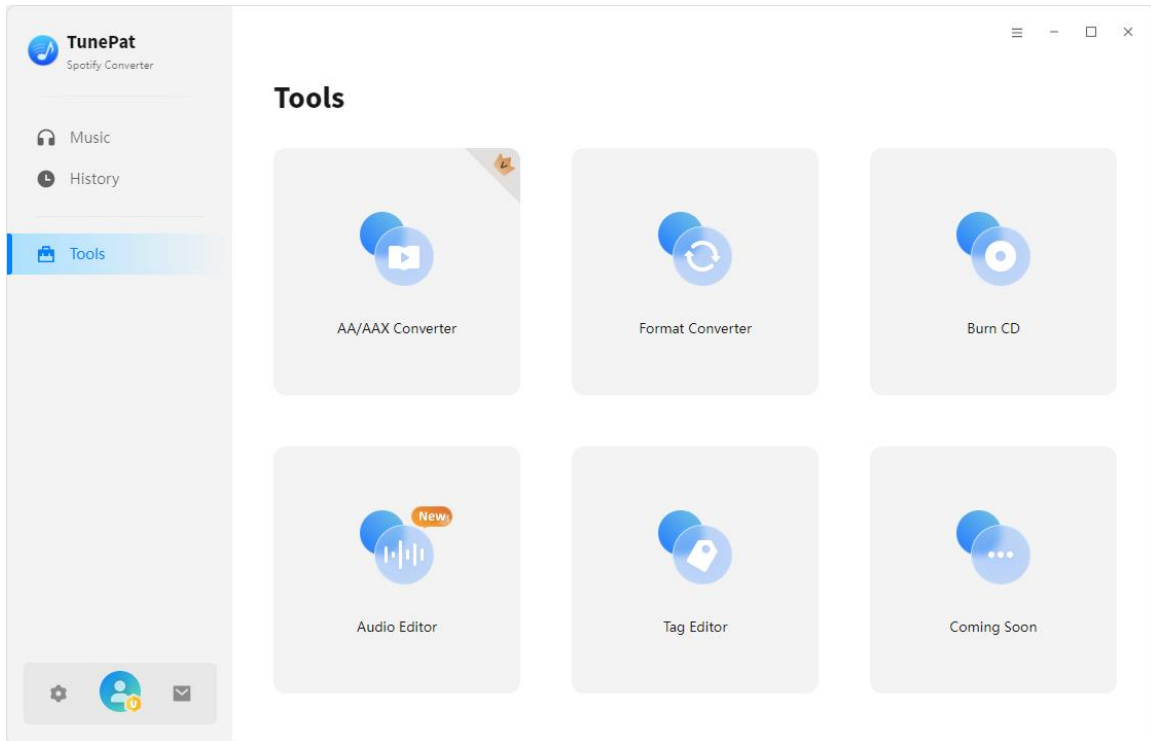



➤ Feedback

There is a **Feedback** option at the bottom of the left menu bar. When you encounter any TunePat related purchase, use, or after-sales questions, you can contact us directly here.

If your program is already registered, the email address on this page will default to the associated email address of your license key. We do not recommend that you modify this email address, because the associated email address can facilitate us to quickly find and locate your order information.

Also, please describe the problem you encountered, and when you encountered a conversion problem, you need to provide the following information when contacting us.

1. Please tell us the details of your computer system.
2. What output format did you choose?
3. Does the problem occur on a specific audio file or all audio files?
4. Please check the Attach log file button below. (Generally, the default is the ticked state)

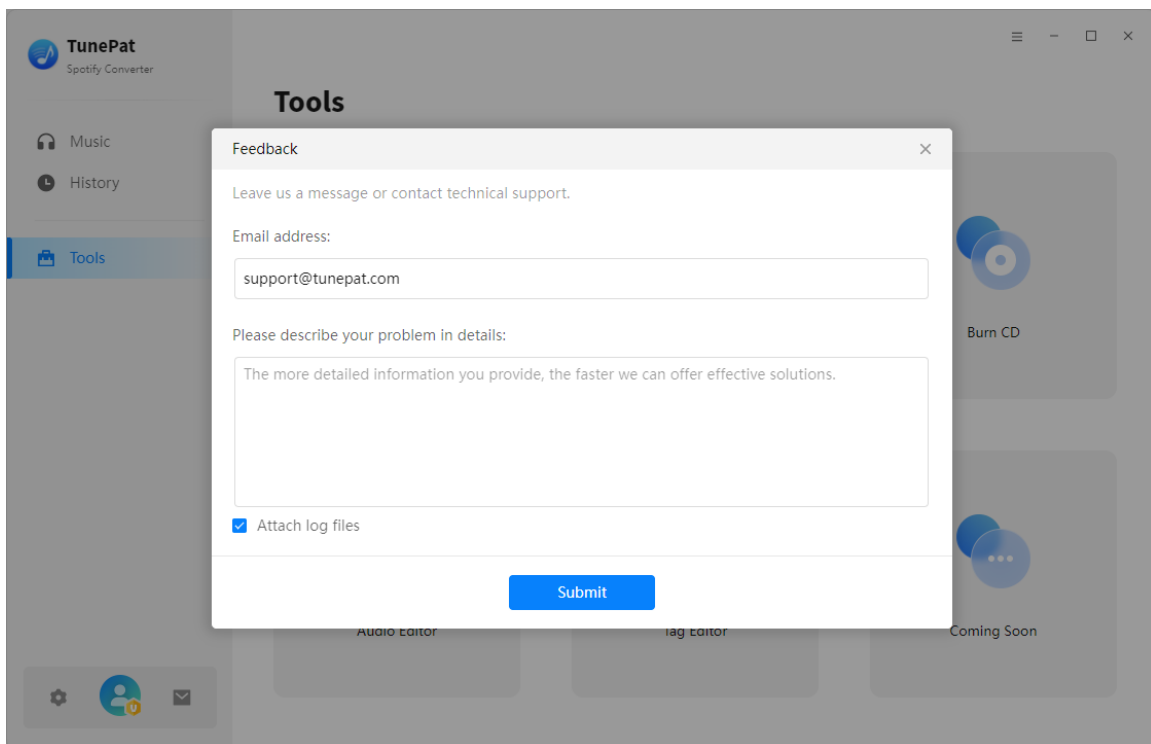



Technical Supports

- [Support](#)
- [Contact](#)

➤ Support

For more information, please visit TunePat's Official Website.

Homepage: <https://www.tunepat.com/>

Product Page: <https://www.tunepat.com/spotify-music-converter.html>

If you meet any problem, you may help yourself with TunePat FAQ.

FAQS Page: <https://www.tunepat.com/support/faq-spotify-music-converter.html>

Support Page: <https://www.tunepat.com/online-help/spotify-converter.html>

➤ Contact

If you meet any problem when using our products, please contact TunePat technical support team for further assistance. Technical support inquiry, suggestion, feedback, proposal, compliments, or even criticism, are all welcomed.

We are always ready to serve you with prompt and useful email support. From Monday to Sunday, we will answer your emails within 48 hours. Please allow time lag due to different time zones.

Support E-mail: support@tunepat.com